

CULOUL RANGE

Autobrick Industries Pty. Ltd. have withdrawn their mining lease application as a result of the unfavourable (for Autobrick) findings of the recent SPCC enquiry.

OFF-ROAD VEHICLES' DAMAGE TO THE ENVIRONMENT

There is an increasingly powerful lobby on behalf of off-road vehicle users seeking to gain access to National Parks in order to enjoy their form of motorised recreation. One group has called for a moratorium on new national parks - in particular, the Deau-Tuross and Colo-Hunter proposals.

In order to counter this lobby, Ted Daniels, convenor of field activities N.P.A., in a letter to Federation has suggested that bushwalkers should provide evidence of damage by off-road vehicles in natural areas.

If you encounter instances of such damage during your walks, the most effective action to take would be to write to Mr. W.F. Crabtree, Minister for Lands, expressing approval of the National Parks & Wildlife Service policy of restricting off-road vehicles in national parks to the public roads. If the instance you are citing is located in an area proposed as but not yet a national park, press the Minister for its early dedication in order to end the damage noted. If the example cited is located in an area not in a proposed or existing national park, you might express your support for the NP & WS policy because of the protection it gives to the more important natural areas in existing or proposed parks.

If possible, you should include photographic evidence with your letter. It would be greatly appreciated if a copy of your letter, and if possible of any photographs sent, could be forwarded to NPA, 399 Pitt Street, Sydney, 2000

Photographs should preferably be black and white, but any colour slides sent in will be copied and returned.

DAVE NOBLE
F.B.W. Conservation
Committee

EVERYTHING FOR THE CAMPER AND BUSHWALKER

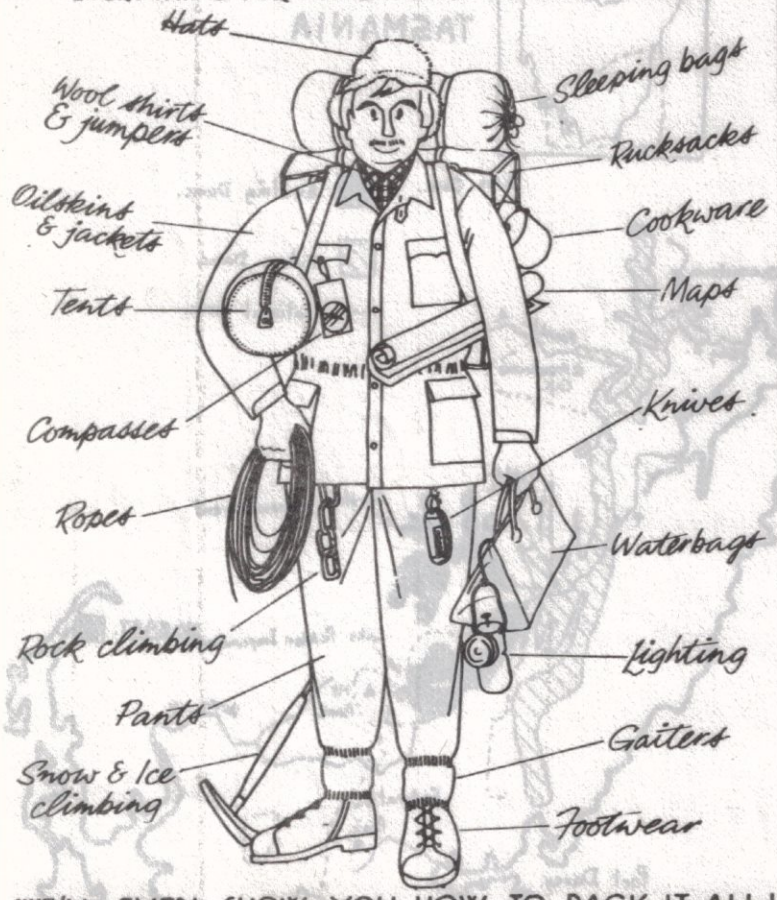

WE'LL EVEN SHOW YOU HOW TO PACK IT ALL!

Paddy Pallin

67-69 LIVERPOOL STREET, SYDNEY, NSW 2000 26 2685
JUST DOWN FROM GEORGE ST
46 NORTHBOURNE AVENUE, CANBERRA, ACT 47 6949
35 HARDWARE STREET, MELBOURNE, VIC 3000 67 4845

SECOND WRAN TOUR OF BLUE MOUNTAINS?

The Colong Committee is hoping that the Premier and Mrs. Wran will accept an invitation to inspect the northern Blue Mountains in spring this year.

TRAVELLING ON YOUR OWN?
OR ORGANISING A GROUP?

Climbing Frenchman's Cap, Annapurna or the Eiffel Tower?

Make your Travel Bookings with

YHA TRAVEL



It costs you no more -
it may cost you less

Any profits made are retained by YHA to provide more facilities and services.

Come and talk to Penny or Peter at

YHA TRAVEL, 355 Kent Street, Sydney.

29-8072

"The hills not only take men away from the complex mode of existence, but they teach them that to be happy it is only necessary to have food, shelter and warmth. They bring them face to face with realities, and in doing so insulate a valuable lesson in the association of simplicity and happiness.On a hill we are content to be content".

"And so from the hills we return refreshed in body, in mind and in spirit, to grapple anew with life's problems. For a while we have lived simply, wisely and happily; we have made good friends; we have adventured well. The hills have taught us to be content in our faith and in the love of God who created them".

Day broke upon the Murray,
The morning mists were gone,
The Magpies sang their matins,
The river murmured on.
Edward Harrington

Hence all who love their country, love
To look on thee - delight to rove
Where they thy voice can hear.

Wordsworth.

KAMERUKA Vol 16 No. 1 is now on sale - 50¢ at Paddys etc. Features articles on the Bylong Labyrinth, food, Claustal at night, the Wollangambe River and an article by the Tasmanian poet, Barney Roberts, on a solo walk on the Central Plateau of Tasmania.

"CULOUL BEHIND US NOW COLO" WEEKEND SEMINAR 6th-7th MAY CULOUL RANGE

Late last year we gave notice of a weekend on the Culoul Range to celebrate stopping the Culoul Shale Mine. However, recently, a greater threat to the area has arisen, namely, a dam on the Colo with its attendant pipeline. Consequently the weekend will take the theme "Culoul Behind Us Now Colo"

The programme for the weekend will be as follows:

Saturday, 6th May

11.00 a.m.

Rendezvous on Putty Road at start of Culoul Range (Map Reference 892364 Sydney 1:250,000) Transport will be provided from her so participants should pack their weekend supplies in one ruck sack suit case etc. Security for cars parked on the Putty Road will be provided.

2.00 - 3 p.m.

Seminars. Anatomy of a Cause - Culoul
Bruce Vote

.History of Private Proposals
over the Colo

National Parks Ass.

.Government Proposals - Parks &
Otherwise

National Parks & Wildlife
Service

.Current Problem & Action
Colo Committee

3.00 - 4 p.m.

Workshops .Is Water from the Colo really
necessary for a Power Station
at Newnes? Is a Power Station
really necessary?
.Political Action
.Fact Finding and Investigation

4.00 - 5 p.m.

Reports on Workshop Leaders

7.30 p.m. Campfire

Sunday, 7th May

9.00 a.m. Daywalks to the cliff tops, the
Colo, & Wollemi Creek. the
Leaders provided.

3.00 p.m. Any comments

3.30 p.m. Transport to Putty Road

All participants should provide own food,
cooking equipment, tents, sleeping bags,
water (approx. 10 litres per person in
plastic bottle or wine bladder) & note
paper & pen. Registration \$5.00 per person.
(To pay for transport, speakers, campfire
supper - surplus to fighting fund)

EASTWOOD CAMPING CENTRE

ALL THE USUAL GEAR:

Fairydown sleeping bags, abseiling gear, parkas, packs
tents, boots, groundsheets, lightweight food, AND
MUCH MORE.

Agents for Lands Department and Division of Nation-
al Mapping topographical maps.

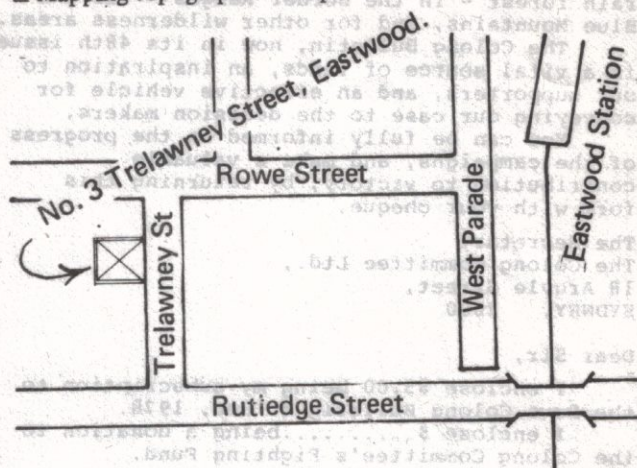

**EASTWOOD CANVAS GOODS AND CAMPING
SUPPLIES**
3 TRELAWNEY STREET, EASTWOOD.
PHONE: 858-2775

BITS AND PIECES

AREAS on the Queensland-NSW Border have now
been accepted by the Australian Heritage
Commission and placed on the National
Estate List.

DISMAL SWAMP near Smithton, Tasmania has
been dedicated State Forest, rather than
national park.

THE land Conservation Study Group, NSW, is
receiving submissions on policies, problems
and procedures involved in the future of
State controlled lands.

FEDERATIONS Search and Rescue Committee has
restructured requirements for active
participation in rescues etc. For

information contact Fergus Bell,
121 Sherbrook Avenue, Asquith, NSW.

INTERNATIONAL Wilderness Conference
scheduled for Queensland in May 1980.

MOST of the Jardine River, on Cape York
Peninsula, has been gazetted national park.
NORTHERN bank of Shoalhaven River to
escarpment (2758.8 ha) gazetted as addition
to Morton National Park.

BUDAWANG National Park gazetted (113,000 ha)
extending south from Morton National Park,
and including Mt. Budawang.

IN a letter to the Tasmanian Premier,
Mr. Doug Lowe, Federation registered its
objection to the proposed development of
the Gordon and/or King River for hydro-
electricity.

FEDERATIONS newly created Outdoor
Recreation Education Committee has begun
the mammoth task of instigating the 2nd
New South Wales Workshop to be held over
a 6 month period in 1978.

P. HARRIS

Send to F.B.W. Box 2090, G.P.O., Sydney
Before 16 April 1978.

Please include persons in the "Culoul Behind Us - Now Colo" weekend.

I enclose \$..... @ \$5.00 per person. Name

Please fill appropriate line & cross out those that do not apply.

- I need transport for people

- My car has been on the Culoul Road and will be fully occupied by my party.

- My car has been on the Culoul Road and I can take extra people with gear.

Drivers will be reimbursed for car usage. (The road is rough and only those drivers who
have used it before should offer their vehicle).